

29833

151588

APPROVED BY CITY COUNCIL  
AUG 26 2015  
*Lois C. L...*  
City Secretary

# NORTH WINNETKA

50' R.O.W.

POWER POLE

OVERHEAD POWER LINE

CONC. SIDEWALK (364 SF IMPERV)

EXIST. CONC. APPROACH

NORTH 104.0'

NORTH 104.0'

NORTH 104.0'

NORTH 104.0'

# McBROOM STREET

50' R.O.W.

EX 6" WATER

CONC. SIDEWALK

CONCRETE APRON (70 SF IMPERV)

3 STORY BRICK

3326 WINNETKA AVE.

STUCCO / WOOD FRAME STRUCTURE (UNSPRINKLERED)  
3,433 CONDITIONED SQUARE FEET ONE STORY Z2

COVERED PATIO

ACCESSIBLE ROUTE

VAN ACCESSIBLE

CONCRETE PARKING, 3 SPACES, 1 HC SPACE

# BENITO JUAREZ PARK

(ZONED R-5(A))

LOT 1 BLOCK A-7103, ZONED R-5(A)

LOT 2 BLOCK A-7103, ZONED R-5(A)

Landscape Plan Specific Use Permit No. 2153

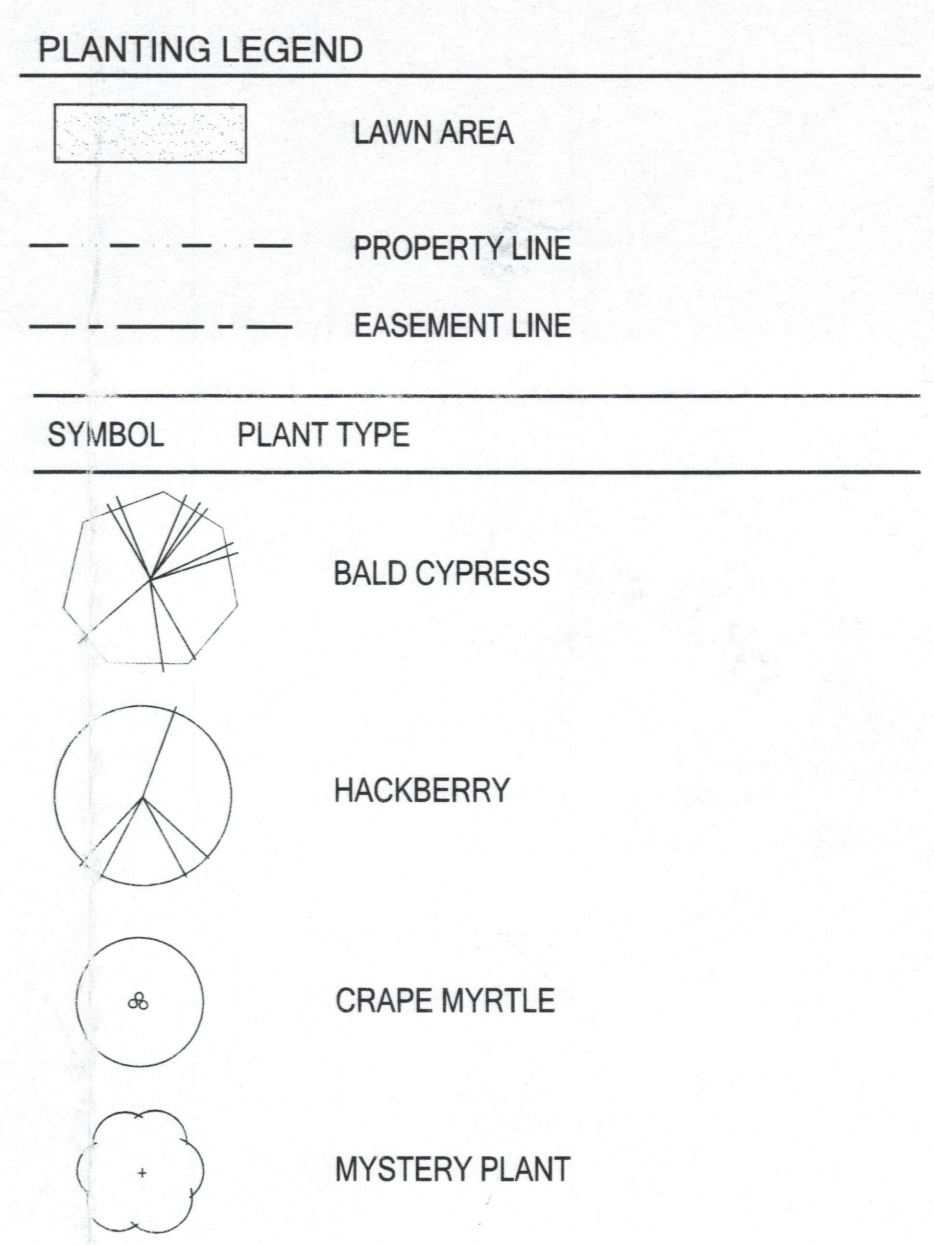
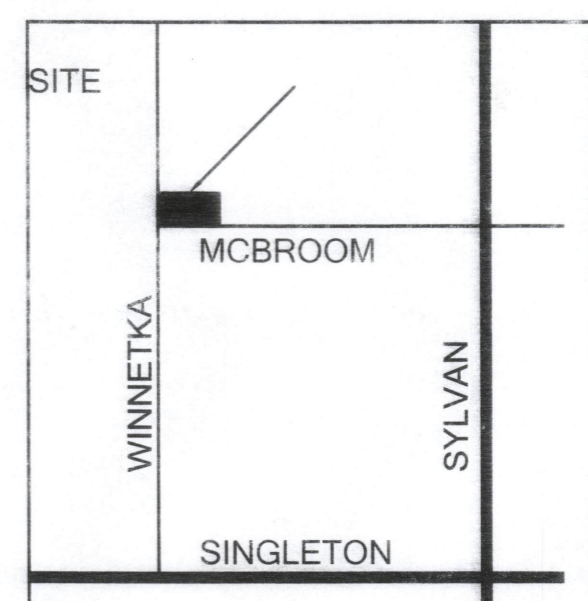

**SARAH WILKE CENTER**  
3326 N. WINNETKA AVENUE  
DALLAS, TEXAS 75212  
**ISSUE FOR CONSTRUCTION**

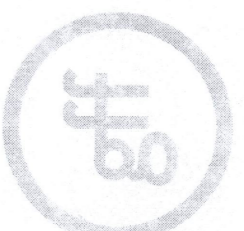

**Good Fulton & Farrell Architects**  
214.303.1500/Tel  
214.303.1512/Fax  
www.gff.com  
2808 Fairmount Street  
Suite 300  
Dallas, Texas 75201  
© Good Fulton & Farrell 2013

Table with 3 columns: No., Date, Item. It contains several rows with arrows pointing to the right, indicating revisions.

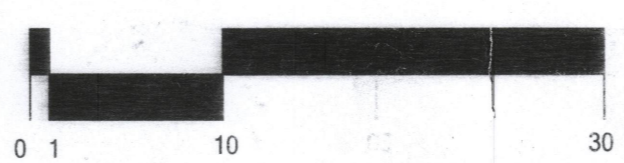

# 01 LANDSCAPE PLAN

File Name: A-SITE-SUP.dwg

Scale: 1" = 10'

VICINITY MAP

2145-266

Project No. 15099.00  
Date 08.14.15

L0.01